



# RIALZI IN ALLUMINIO PER MORSE COMPACT GRIP ART.650 / 950

## ALUMINUM RISERS FOR COMPACT GRIP VISES ART.650 / 950

Tipo (grandezza) rialzo Riser (type) size		1												
<b>Art. 651H</b> <i>Tipo / Type 1</i> Rialzo semplice, compatibile con il sistema Zero Point 	A	80				120				160				
	B	80				80				80				
	* C	50	75	100	50	75	100	50	75	100				
	ØD	128				178				178				
	E	-				150				150				
	L	52				52				52				
	M	52				52				52				
	ØJ	110				150				150				
	K	10				10				10				
	K1	-				16				16				
	kg	1,08	1,41	1,75	2,09	2,63	3,17	2,40	3,15	3,90				
	Cod.	7.65.1H1080/050	7.65.1H1080/075	7.65.1H1080/100	7.65.1H1120/050	7.65.1H1120/075	7.65.1H1120/100	7.65.1H1160/050	7.65.1H1160/075	7.65.1H1160/100				
	Simple riser Zero Point ready													

 Kit di fissaggio e allineamento rialzo **non incluso** / Riser fixing and alignment kit **not included**

Tipo (grandezza) rialzo Riser (type) size		2													
<b>Art. 651H</b> <i>Tipo / Type 2</i> Rialzo semplice, compatibile con il sistema Zero Point 	A	120				160				200				240	
	B	90				90				90				90	
	* C	50	75	100	50	75	100	50	75	100	50	75	100		
	ØD	210				210				210				249	
	E	-				150				150				200	
	L	65				65				65				65	
	M	90				90				90				150	
	ØJ	185				185				185				185	
	kg	3,07	3,71	4,32	3,09	3,90	4,73	3,38	4,45	5,52	4,13	5,45	6,75		
	Cod.	7.65.1H2120/050	7.65.1H2120/075	7.65.1H2120/100	7.65.1H2160/050	7.65.1H2160/075	7.65.1H2160/100	7.65.1H2200/050	7.65.1H2200/075	7.65.1H2200/100	7.65.1H2240/050	7.65.1H2240/075	7.65.1H2240/100		
	Simple riser Zero Point ready														

 Kit di fissaggio e allineamento rialzo **non incluso** / Riser fixing and alignment kit **not included**

Tipo (grandezza) rialzo Riser (type) size		3															
<b>Art. 651H</b> <i>Tipo / Type 3</i> Rialzo semplice, compatibile con il sistema Zero Point 	A	160				210				260				310		360	
	B	125				125				125				125		125	
	* C	50	75	100	50	75	100	50	75	100	50	75	100	50	75	100	
	ØD	240				240				332				327		373	
	E	150				150				150				150		200	
	E1	-				-				200				200		250	
	L	96				96				96				96		96	
	L1	-				-				-				100		100	
	M	96				96				96				96		96	
	M1	-				-				-				200		250	
	ØJ	185				185				185				185		185	
	ØJ1	-				-				290				290		290	
	kg	3,34	4,49	5,68	3,85	5,40	6,99	5,73	7,69	9,69	6,14	8,50	10,91	7,02	9,80	12,62	
	Cod.	7.65.1H3160/050	7.65.1H3160/075	7.65.1H3160/100	7.65.1H3210/050	7.65.1H3210/075	7.65.1H3210/100	7.65.1H3260/050	7.65.1H3260/075	7.65.1H3260/100	7.65.1H3310/050	7.65.1H3310/075	7.65.1H3310/100	7.65.1H3360/050	7.65.1H3360/075	7.65.1H3360/100	
	Simple riser Zero Point ready																

 Kit di fissaggio e allineamento rialzo **non incluso** / Riser fixing and alignment kit **not included**

**PIASTRE di INTERFACCIA**  
**INTERFACE PLATES**
**Tipo (grandezza)**  
 Riser (type) size

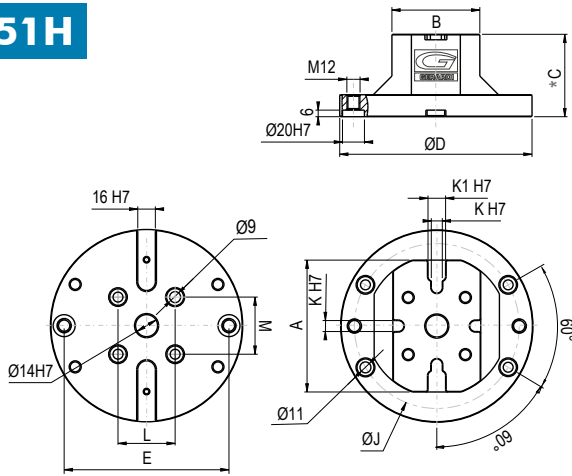
**1**
**Art. 651H**

**Tipo (grandezza)**  
 Riser (type) size

**1**
**Art. 62M**
**CompactGrip**

 Piastra di interfaccia lavorabile  
 Machineable interface plate

ØJ	110	150	150
C1	28		
Cod.	7.62.M651H21...		
	.../108	.../112	.../116

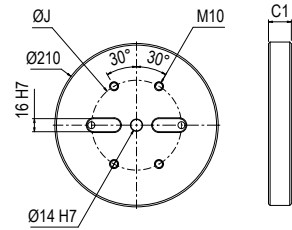
Personalizzazione non inclusa - Customization not included

 Kit di fissaggio al rialzo **incluso** / Riser fixing and positioning kit **included**
**Tipo (grandezza)**  
 Riser (type) size

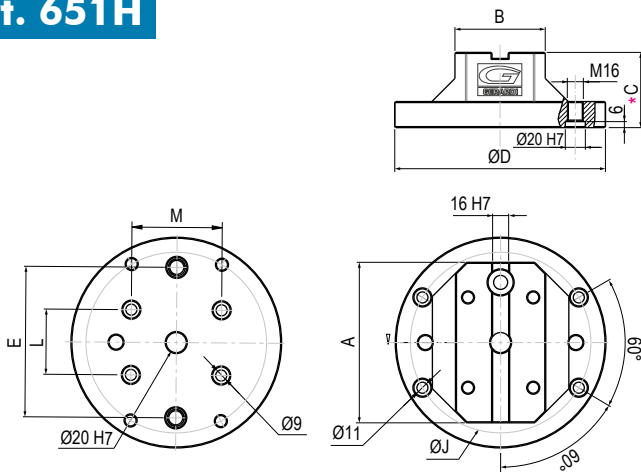
**2**
**Art. 651H**

**Tipo (grandezza)**  
 Riser (type) size

**2**
**Art. 62M**
**CompactGrip**

 Piastra di interfaccia lavorabile  
 Machineable interface plate

ØJ	185			
C1	28			
E	-	150	150	200
Cod.	7.62.M651H31/			
	.../212	.../216	.../220	.../224

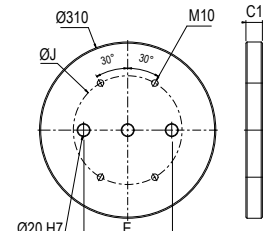
Personalizzazione non inclusa - Customization not included

 Kit di fissaggio al rialzo **incluso** / Riser fixing and positioning kit **included**
**Tipo (grandezza)**  
 Riser (type) size

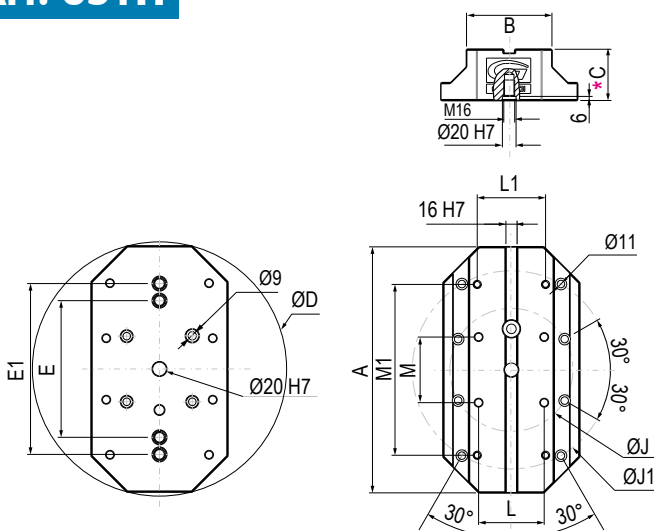
**3**
**Art. 651H**

**Tipo (grandezza)**  
 Riser (type) size

**3**
**Art. 62M**
**CompactGrip**

 Piastra di interfaccia lavorabile  
 Machineable interface plate

ØJ	185				
C1	28				
J1	-	-	290	290	290
E	150	150	150	150	200
Cod.	7.62.M651H45/				
	.../316	.../321	.../326	.../331	.../336

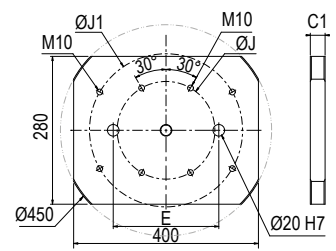
Personalizzazione non inclusa - Customization not included

 Kit di fissaggio al rialzo **incluso** / Riser fixing and positioning kit **included**

# MORSE COMPACT GRIP

## COMPACT GRIP VISES

Esempi applicativi su centri a 5 assi - Application example on 5 axis machine

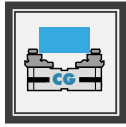

Morse Compact Grip  
Compact Grip vises



lavorazioni a 5 assi  
5 axis machining

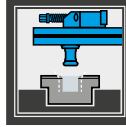

Predisposizione  
Zero Point  
Zero Point ready

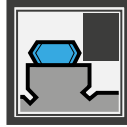

Inseri GRIP  
GRIP inserts



### Art.650 Compact Grip

La novità assoluta per centri a 5 assi e sistemi multipli sono le morse autocentranti Compact Grip. Il loro nome accosta le principali peculiarità della morsa date dall'estrema compattezza e maneggevolezza al nome del sistema di inserti che adotta, cosiddetto "GRIP". Questo sistema consiste in una gamma di inserti ganascia modulari montati sopra al corpo ganascia principale con la funzione di serrare il particolare da lavorare tramite dei dentini affilati o conformati a seconda del tipo di materiale e di durezza.

The absolute news for 5 axis machine centres and new multiclamping system are the self-centering Compact Grip vises. Their name identifies the main vise features which are the extreme compactness and easiest handling and the system of inserts which adopts, so called "GRIP". This system includes a range of jaw plates assembled on the top of the main jaw with the function of clamping the workpiece through sharp or duly shaped teeth according to the material type and hardness to clamp.

### Aperture Morse / Opening vise range



Scansiona il QR code e scarica la tabella con tutte le aperture delle morse CompactGrip

Scan the QR code to download the chart with all vise jaws opening

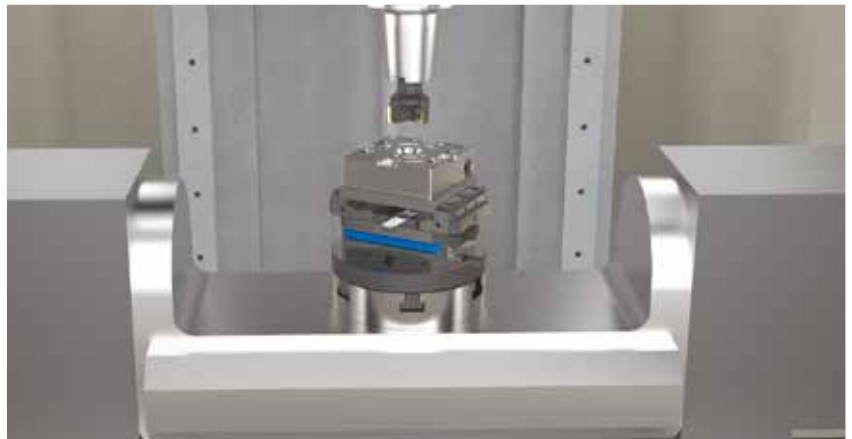

Tramite l'inserto Grip si esegue la sgrossatura e la finitura del pezzo sui cinque lati.  
Through the Grip insert you can rough mill and finish the workpiece on five sides.



Dettaglio Inserto Grip.  
Insert Grip detail.

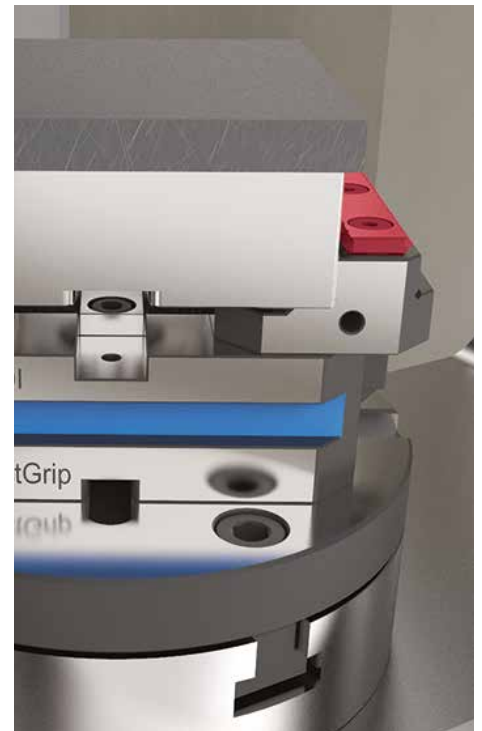

Tramite il gradino liscio della ganascia si rimuove il sovrametallo rimanente e si finisce il particolare  
Then through the smooth jaw step you can remove the remaining stock allowance from the workpiece and finish the workpiece

## MORSE FMS

### FMS VISES

#### Esempi applicativi su centri a 5 assi - Application example on 5 axis machine

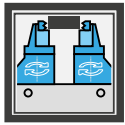

Ganasce alte e rialzate  
High and raised jaws



lavorazioni a 5 assi  
5 axis machining

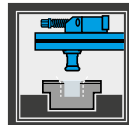

Predisposizione  
Zero Point  
Zero Point ready

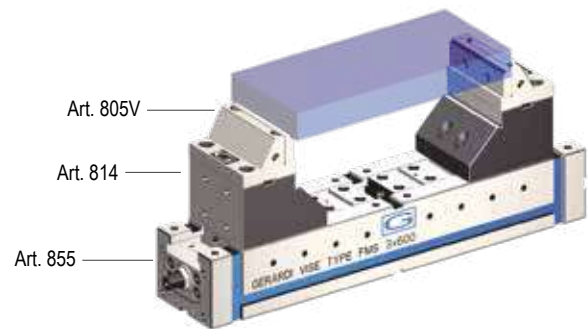

### Art.868 FMS series

Grazie all'estrema versatilità del sistema modulare Gerardi anche le morse FMS, adeguatamente riconfigurate, possono rientrare nella cosiddetta categoria di morse Multitasking per centri di lavoro a 5 assi.

Basterà quindi montare la base mobile Art.814 con le relative ganasce Art.805V sul modulo base universale Art.855.

Thanks to the extreme versatility of the Gerardi Modular System even the FMS vises, properly reconfigured, can be used as Multitasking vises for 5 axis machine centres.

It will be enough to assemble the movable base Art.814 with the Art.805V jaws on the universal vise base module Art.855

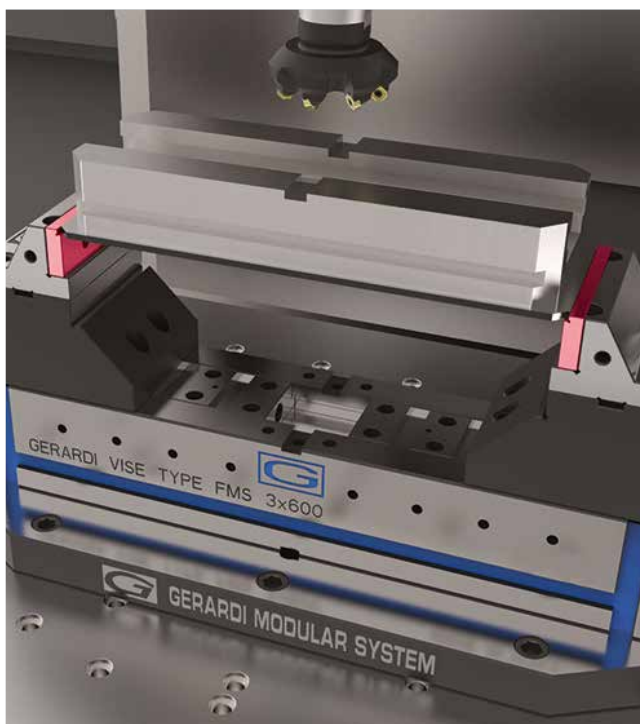
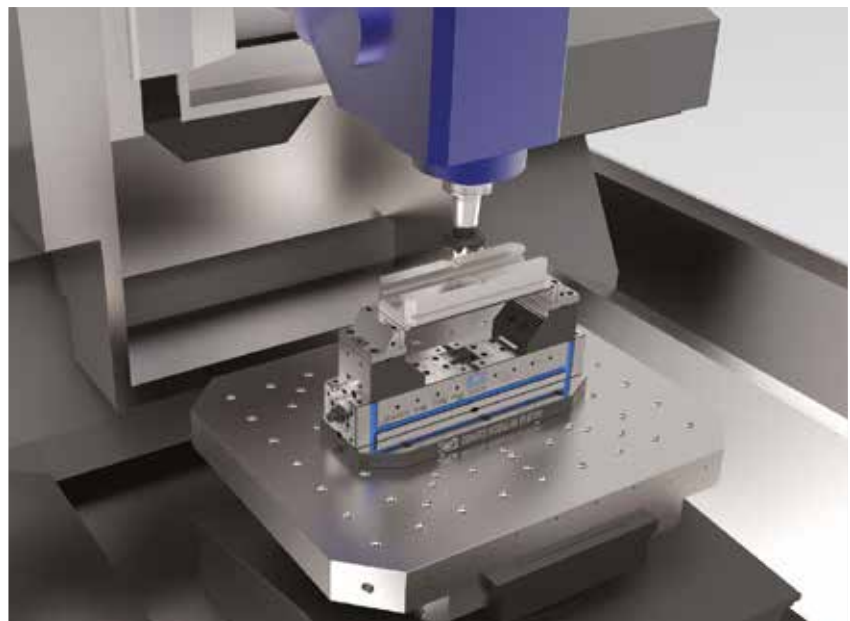

Particolare sollevato tramite base mobile Art.814  
Workpiece raised by movable base Art.814



Dettaglio serraggio tramite piastrina GRIP Art.247T  
Detail of clamping by GRIP jaw plate Art.247T



# Staffe di ancoraggio / Vise holding clamps

**NEW**  
**2024**

## CompactGrip

**Coppia staffe di fissaggio Art.296, complete di vite e dado a "T"**
*Pair of vise holding clamps Art.296 complete of screw and "T" nut*

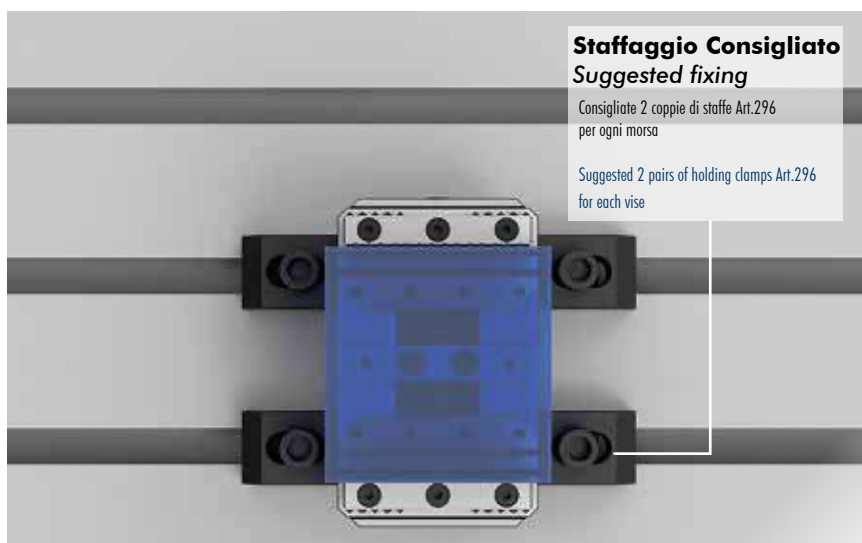
**Esempio d'ordine per morsa tipo 3 su macchina con cave a T da 18mm: Art.296 T.3 X=18mm**
**Oppure con codice: 2.29.6100 X=18mm**
*Order example for Type 3 vise on machine with 18mm T-slots: Art.296 T.3 X=18mm*
*Also with code: 2.29.6100 X=18mm*

**Staffaggio Consigliato**  
**Suggested fixing**

Consigliate 2 coppie di staffe Art.296 per ogni morsa

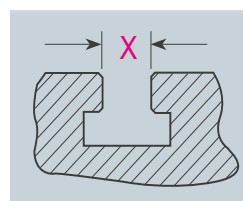
Suggested 2 pairs of holding clamps Art.296 for each vise

**Cava a T**
**T Slot**

Specificare sempre la cava della vostra macchina

Always specify the machine T-slot dimension

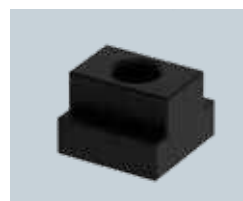
**Art.287 (Pag.4.34)**
**Dadi a T - T Nuts**

Per fissaggio morse alle cave a T della macchina

For vise clamping on the machine T-slots

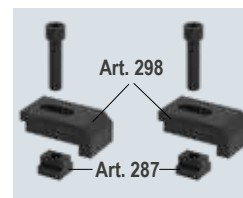
**Art.296**

(Art.298 + Art.287)

Consigliate 2 coppie di staffe Art.296 per ogni morsa

Suggested 2 pairs of holding clamps Art.296 for each vise

**Art.298/CGR**

 Per lo staffaggio della morsa in spazi ristretti possibilità di usare staffe Art. 298 / CGR vedi pag. 7.29  
 For clamping vise in narrow space it's possible to use the holding clamps Art 298 / CGR see pages 7.29

**7**

Tipo (grandezza) morsa Vise type (size)	1 - 2 - 3									
	Cava a T-slot X	12*	14	16	16	18	20	18*	20	22
<b>Art. 296</b>	T-nuts Ref. N°	12	13	14	20	21	22	32	33	34
<b>Coppia di staffe</b> Holding clamps pair	Filetto vite Screw thread	<b>M10</b>			<b>M12 *</b>			<b>M16</b>		
	A	50			50			50		
	B	24			24			24		
	C	6			6			6		
	Ø D	11			13			17		
	E	10			10			10		
	G	16			17,5			19		
	G1	15			13			9		
	H	34			34			34		
	J	4			4			4		
T ± 0,1	15			15			15			
Cod.	2.29.61000 / M10			2.29.61000 / M12			2.29.61000 / M16			

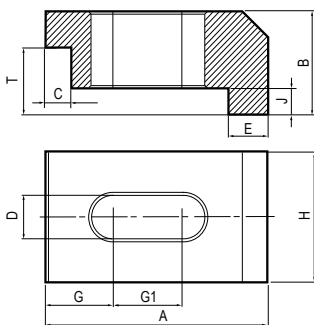

\* Scelta consigliata - Suggested choice

\* Scelta NON consigliata - NO Suggested choice

## Soluzioni personalizzate / Customized solutions

# 4th & 5th Axis

### Soluzioni personalizzate a tutti i vostri problemi di serraggio

*Customized solutions for all your clamping problems*

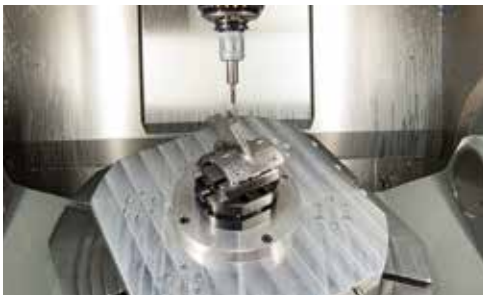

#### **Morsa Multitasking su centro a 5 assi**

*Multitasking vise on 5th axis machining center*

**Applicazione aeronautica, morsa Art.640 tipo 2 montata su macchina a 5 assi**

Typical Multitasking vise Art.640 type 2 application on a 5 axis machine for aerospace workpiece

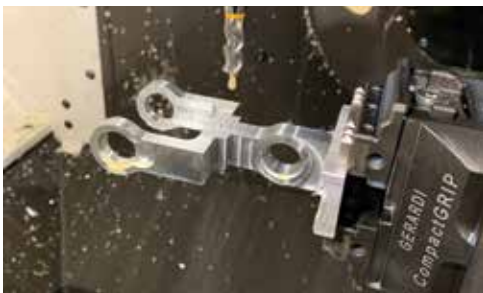

#### **Morsa CompactGrip su centro a 5 assi**

*CompactGrip vise on 5th axis machining center*

**Lavorazioni di fresatura effettuate su di un centro di lavoro a cinque assi con morsa CompactGrip Art.650**

Milling machining operations on a five axis machining center with CompactGrip vises Art650



#### **Morsa CompactGrip su rialzo semplice**

*Compact Grip vise on simple riser*

**Morsa CompactGrip montata su Kitamura Mytrunnion 4G per la lavorazione di uno stampo nel settore plastica.**

Compact Grip vise on Kitamura Mytrunnion-4G for machining a die mould used in the plastic industry



#### **Morse CompactGrip su piastra Zero Point**

*CompactGrip vises on Zero Point plate*

**Piastra base con 6 Zero Point singoli per morsa CompactGrip Art.650 T2 per lavorazioni di piccoli particolari**

Zero Point plate with 6 single Zero Point units for CompactGrip vises Art.650 T2 for small workpieces machining.



#### **Un sistema completamente automatico**

*Fully automatic system*

**Morsa automatica GripMatic Art.670PN montata tramite robot su tavola Zero Point.**

GripMatic automatic vises Art.670PN mounted by robot on Zero Point Plate

# VALIGETTA DI CAMPIONATURA COMPACT GRIP

## SAMPLE KIT CASE COMPACT GRIP

**Art. 986**

Art.650

Art.660

**Morsa / Vise Art. 650**

Cod. 0.98.60000

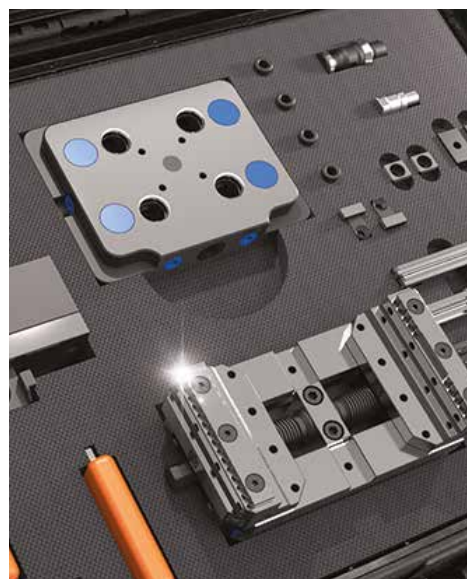
**Art. 650 - All'Interno - Inside:**

## SIMBOLOGIA DATI TECNICI

## TECHNICAL DATA ICONS

<b>GANASCE</b> <b>JAWS</b>						<b>POSSIBILITÀ</b> <b>POSSIBILITY</b>						
	Morse Multitasking vises	Morse Compact Grip Compact Grip vises	Morse Compact Grip Art. 950 Compact Grip vises	Morse Grip Matic Grip Matic vises	Sistema a coda di rondine Dove Tail fixtures		Montaggio con centralina Mounting with power unit	Lavorazioni a 5 assi 5 axis machining	Predisposizione Zero Point Zero Point Ready			
<b>PIASTRE</b> <b>GANASCE</b> <b>JAW PLATES</b>						<b>PAGINE</b> <b>PAGES</b>						
	Liscio + Ruvido Smooth + Rough	Coda di Rondine Dove Tail	GRIP GRIP	Frontali Frontal	Rialzi Risers		Sistema Pneumatico Pneumatic system	Sistema Idraulico Hydraulic system	Accessori & Ricambi Accessories & Spare Parts	Istruzioni corretto utilizzo Instruction for a proper use	Diagrammi forze di serraggio Clamping force diagrams	

## OPZIONI LAVORAZIONI EXTRA

## OPTIONS FOR EXTRA MACHINING

 Nei codici, **FMS** si riferisce agli articoli dei gruppi 5, 6 e 7.  
 In codes, **FMS** refers to articles in groups 5, 6 and 7.

Lavorazione extra Extra machining	Cod.	Lavorazione extra Extra machining	Cod.
AGGIUNTA di un foro calibrato ADDITION of a calibrated hole	MAN-010-FMS	MONTAGGIO SEMPLICE SIMPLE ASSEMBLY	MAN-060-FMS
AGGIUNTA di una chiave calibrata ADDITION of a calibrated key-way	MAN-020-FMS	MONTAGGIO ed ALLINEAMENTO (Standard) (Standard) ASSEMBLY and ALIGNMENT	MAN-070-FMS
PREDISPOSIZIONE SEMPLICE SIMPLE SET UP	MAN-030-FMS	MONTAGGIO VERTICALE COMPLETE VERTICAL ASSEMBLY	MAN-080-FMS
PREDISPOSIZIONE & MONTAGGIO COMPLETO COMPLETE SET UP & MOUNTING	MAN-040-FMS	ALLINEAMENTO e CONTROLLO tramite DEA ALIGNMENT and CONTROL by DEA \ CMM	MAN-090-FMS
MONTAGGIO PARZIALE PARTIAL ASSEMBLY	MAN-050-FMS	TABULATO controllo DEA PRINTOUT DEA control	MAN-100-FMS

Vedi pagina 7.64 per esempi applicativi - See page 7.64 for application examples